



GULF COAST CENTER
PRECISION
ENVIRONMENTAL
HEALTH

2023 NIEHS EHSCC MEETING AGENDA

Hosted by GC-CPEH
Community Forum, October 16, 2023
EHSCC Meeting, October 17 – 19, 2023
The Westin Houston Medical
Center/Museum District
1709 Dryden Rd, Houston, TX 77030

Monday, October 16, 2023: Pre-Meeting Event – Community Forum

| | |
|--------------------|---|
| 8:00 am | Shuttle bus departs Westin Hotel |
| 9:30 am - 11:00 am | Stop 1: Tour of Jones Rd. Superfund neighborhood |
| 11:30 am - 12:45pm | Lunch with Community Partners |
| 1:15 pm - 2:15 pm | Stop 2: Ship Channel and adjacent neighborhoods. |
| 4:00 pm - 5:30 pm | Community Forum at the Houston Health Museum - Sharon Croisant, GC-CPEH |

Tuesday, October 17, 2023- All times CDT

| | All | Science Track | Community Engagement Core (CEC) | Business Admin (BA) |
|---------------------|--|--|--|---|
| 10:00 am - 11:30 am | | | (VERDURE/CARMINE) CEC Welcome and Icebreaker | |
| 11:30 am - 1:00 pm | (Lobby) Registration & (CERISE) Poster setup | | (VERDURE/CARMINE) Itineraries for CEC participants | |
| 12:00 pm - 1:00 pm | (Lobby & Azure III) Lunch and Meet & Greet | | | |
| 1:00 pm - 1:15 pm | (AZURE I & AZURE II) Conference Opening: GC-CPEH Director | | | |
| | Cheryl Walker | Gulf Coast Center for Precision Environmental Health (GC-CPEH) | | |
| 1:15 pm - 2:00 pm | (AZURE I & AZURE II) Opening Keynote - "2023 EHSCC: Looking to the Future of Environmental Health Sciences" | | | |
| | Speaker | Rick Woychik | National Institute of Environmental Health Sciences | |
| | Chair | Cheryl Walker | GC-CPEH | |
| 2:00 pm - 2:20 pm | (Lobby) Coffee Break | | | |
| 2:20 pm - 3:40 pm | (AZURE I & AZURE II) Plenary Session A – Environmental Contributions to Health Disparities | | | (SIENNA) 2:20 - 3:40 |
| | Chair | Gail S. Prins | UIC CACHET | |
| | Co-Chair | Marsha Wills-Karp | Hopkins CHARMED | |
| | 2:20-2:40 | Ami Zota | Advancing Beauty Justice Through Solutions-Oriented Research | Columbia N. Manhattan |
| | 2:40-3:00 | Kirsten Koehler | Particulate Exposures Among Inner-City Children with Asthma | Hopkins CHARMED |
| | 3:00-3:20 | Ayca Erkin-Cakmak | Early-life Exposure to Persistent Organic Pollutants and Cardiometabolic Health in Young Adults from the CHAMACOS Cohort | UCSF EaRTH |
| | 3:20-3:40 | Nicholas J. Spada | Computer Vision and AI for Monitoring Mobile Sources in Front-Line Communities: A Case-Study Quantifying Air Quality Impacts from Coal-Carrying Trains in Richmond, CA | UC Davis EHSC |
| 3:50pm - 5:30 pm | (CERISE) Networking and Poster Session – Group photo at 4pm <i>Poster presenters will be at their posters during the designated times as follows:</i> | | | (SIENNA) 4:30 - 5:10 BA EHSCC P30 Program Overview |
| | | • 4-4:45: ESI/Climate/DR2 | | |
| | | • 4:45-5:30: CEC | | |
| 5:30 pm - 6:00 pm | Shuttle Buses Depart Hotel for Reception at the Museum | | | |
| 6:00 pm - 9:00 pm | Reception at the Houston Museum of Natural Science Morian Hall of Paleontology Heavy Hors d'oeuvres / <i>Optional Group Photo at 6:20</i> | | | |
| 8:30 pm - 9:30 pm | Shuttle Buses Depart Reception for Hotel | | | |
| | | | | Claudia Thompson, NIEHS |

Wednesday, October 18, 2023

| | All | Science Track | Center Directors | CEC | BA <i>(SIENNA)</i> | |
|--------------------|---|--|--|---|--|--|
| 8:30 am - 9:30 am | <i>(Lobby & Azure III)</i> Breakfast and <i>(CERISE)</i> Poster Viewing- Continental breakfast | | | <i>(VERDURE/CARMINE)</i> CEC Breakfast/Informational Session | | |
| 9:30 am - 11:15 am | <i>(AZURE I & AZURE II)</i> Informational Workshop: Precision Environmental Health Initiatives: At the end of the presentations, all speakers will participate in a Q&A about how these programs/tools benefit the community. | | | <i>(VERDURE/CARMINE)</i> 9:30-11:15 CEC Panel Sessions 1 Translating Research for Policy and Advocacy Organizer: Jonathan London, UC Davis EHSC | 9:30-11:15 Data Collection & Reporting followed by Group Discussion Kristianna Pettibone, NIEHS | |
| | Chair | Claudia Thompson | NIEHS | | | |
| | Co-Chair | Elaine Symanski | GC-CPEH | | | |
| | 9:30-10:00 | ECHO (Environmental Influences on Child Health Outcomes) | Matthew W. Gillman | | | ECHO Director |
| | 10:00-10:20 | NCI/NIEHS Cancer and Environment Cohort (CEECC) | Cathrine Hoyo | | | NC State CHHE |
| | 10:20-10:40 | Newborn Bloodspot Registries | Janine M LaSalle | | | UC Davis EHSC |
| | 10:40-11:00 | All of Us | Brisa Aschebrook | | | UIC CACHET |
| | 11:00-11:15 | 15min Q&A session with speakers | Facilitators: Thompson and Symanski | | | |
| 11:15 am -12:30 pm | <i>(Lobby & Azure III)</i> Lunch Buffet | | | | | |
| 12:30 pm - 1:30 pm | <i>(CERISE)</i> Poster Viewing | | | <i>(VERDURE/CARMINE)</i> 11:30 - 1:30 Center Directors Meet with NIEHS Director Woychik over lunch Chairs/Organizers: Claudia Thompson /Liam O'Fallon | <i>(AZURE I & AZURE II)</i> 11:30-1:15 Shark Tank Talks over lunch Organizer: Kristianna Pettibone, NIEHS | 12:30 - 1:30 Leveraging AI Tools in Research Administration Rozalyn Paupaw, Mount Sinai Carolina Montes Garcia, Columbia |
| 1:30 pm - 3:50 pm | <i>(AZURE I & AZURE II)</i> Plenary Session B- Early-Stage Investigators Spotlight | | | <i>(VERDURE/CARMINE)</i> 1:30- 2:30 CEC Methods Discussion -Evaluation -Infographics -Wildfires/ -Other Disasters <i>(VERDURE/CARMINE)</i> 2:30-4:00 CEC Panel Session 2: Climate Change Organizer: Lisa Hayward, UW EDGE | 1:30 - 3:00 Grants Management Policies & Practices James Williams, NIEHS Clark Philips, NIEHS | |
| | Chair | Susan Pinney | UC CEG | | | |
| | Co-Chair | Weston Porter | Texas A&M TICER | | | |
| | 1:30-1:50 | Nadine Kotlarz | Characterizing Community Exposure to Emerging, Drinking Water-associated Per- and Polyfluoroalkyl Ether Acids | | | NC State CHHE |
| | 1:50-2:10 | Corina Lesseur Perez | Maternal PFAS Exposure and SARS-CoV-2 IgG Antibody Levels During Pregnancy | | | Mt. Sinai HEALS |
| | 2:10-2:30 | Donghai Liang | Use of Single- and Multi-omics to Measure Internal Exposures and Investigate the Molecular Mechanisms Accounting for the Complex Health Responses to air Pollution | | | Emory HERCULES |
| | 2:30-2:50 | Shelly Alexandra Buffington | Maternal Genome-Microbiome-Environment Interactions Influence Neurodevelopment and Risk for Neurodevelopmental Disorders in Offspring | | | GC-CPEH |
| | 2:50-3:10 | Bambarendage Pini Perera | Emerging Roles of PIWI-interacting RNA in Toxicogenetics Research: Sex- and Tissue-Specific Molecular Mechanisms Associated with Perinatal Exposure to Lead (Pb) | Michigan M-LEEaD | | |
| | 3:10-3:30 | Georgios Kelesidis | Global Warming Air Pollutants: From Mobile Sources to Wildfires | Rutgers CEED | 3:20-3:50 Structure of Review Committees & Peer Review Process, Part I Cornelis "Kees" Elferink, GC-CPEH | |
| | 3:30-3:50 | Manuel Garcia-Jaramillo | Protecting Human Health by Applying Novel Approaches to Assess Urban and Rural Drinking Water | OSU Pacific Northwest | | |
| 3:50 pm - 4:10 pm | <i>(Lobby)</i> Coffee Break | | | | | |
| 4:10 pm - 5:30 pm | <i>(AZURE I & AZURE II)</i> Plenary Session C: Multi-Omic Approaches to Precision Environmental Health | | | <i>(VERDURE/CARMINE)</i> 4:10 - 5:30 CEC Roundtables -Report Back -PFAS/Clean Water -Anti-Racism/Anti- Oppression -Sharing Best Practices | 4:10 - 5:30 BA Structure of Review Committees & Peer Review Process, Part II Leroy Worth Jr, NIEHS | |
| | Chair | Dana Dolinoy | Michigan M-LEEaD | | | |
| | Co-Chair | Andrea Baccarelli | Columbia N. Manhattan | | | |
| | 4:10-4:30 | Jarek Meller | Multiomics Signatures of Cancer Progression in ccRCC | | | UC CEG |
| | 4:30-4:50 | Carolyn Klinge | Diet and Exposures to Polychlorinated Biphenyls Regulate the Liver Epitranscriptome in a Mouse Model of Metabolic Dysfunction-Associated Steatotic Liver Disease | | | U. Louisville CIEHS |
| | 4:50-5:10 | Cristian Coarfa | Implementing Precision Environmental Health Using Data Mining with Multi-Omic Molecular Profiles | | | GC-CPEH |
| | 5:10-5:30 | Douglas Walker | Establishing a Molecular Phenotyping Framework to Construct the Cancer Exposome Atlas | Emory HERCULES | | |
| 5:30 - 7:30 pm | <i>(Azure III)</i> Happy Hour Networking – Dinner on Your Own | | | | | |

Thursday October 19, 2023

| | | | |
|--|---|--|--|
| | All | Climate/DR2- A | BA (SIENNA) |
| 8:00 am - 9:30 am | <i>(Lobby & Azure III)</i> Breakfast & Poster Viewing | | |
| 8:30 am - 9:30 am | <i>(AZURE I & AZURE II)</i> Climate Change/DR2 Breakfast Challenges of Communicating the Findings of Climate Change/DR2 Research with Diverse Audiences | | |
| | Facilitator 1 | Aubrey Miller | NIH |
| | Facilitator 2 | April Bennett | NIEHS |
| | Facilitator 3 | Stephen Linder | GC-CPEH |
| 9:30 am - 10:50 am | <i>(AZURE I & AZURE II)</i> Plenary Session D: Climate Change, DR2 and Health | | 9:30-10:10 |
| | Chair | Trevor Penning | UPENN CEET |
| | Co-chair | Abi Oluoyomi | GC-CPEH |
| | 9:30-9:50 | Mary Rice | Temperature, Air Pollution and Daily Respiratory Health among Older Adults with COPD Living in an Urban Environment Harvard Chan Center |
| | 9:50-10:10 | Blanca Himes | Assessing the Impact of Climate Change on Asthma Risk Factors in Environmental Justice Areas in Philadelphia UPENN CEET |
| | 10:10-10:30 | Keith Bein | Wildfire Toxicology: Fingerprinting Chemico-Toxicological Triggers in Wildfire Emissions UC Davis EHSC |
| | 10:30-10:50 | Judy Westrick | How a VOC Community Monitoring Project led to Emergency Readiness in the East Palestine, Ohio Train Derailment Wayne CURES |
| | | | NIEHS Communications & Media Liam O'Fallon, NIEHS |
| | | | 10:15-10:50 BA Session Closing & Next Meeting Heyreoun An Han, GC-CPEH |
| 10:50 am - 11:15 am | <i>(Lobby)</i> Coffee Break | | |
| 11:15 am - 12:00 pm | <i>(AZURE I & AZURE II)</i> Closing Keynote - "Insights in AI: Medicine and Public Health" | | |
| | Speaker | Thomas Hartung | Hopkins CHARMED |
| | Chair | Kees Elferink | GC-CPEH |
| 12:00 pm - 12:30 pm | <i>(AZURE I & AZURE II)</i> 2024 EHSC Meeting Announcement | | |
| | Cheryl Walker | GC-CPEH | |
| 12:30 pm - 1:30 pm | <i>(Lobby)</i> Boxed Lunch, <i>(CERISE)</i> Take Down Posters | | |
| Special Climate Change/DR2 Workshop Session <i>(AZURE I & AZURE II)</i> | | | |
| 1:00 pm - 1:05 pm | Introduction | Abi Oluoyomi | GC-CPEH |
| 1:05 pm - 1:25 pm | Selected ESI Flash Talks (10 min each) | | |
| | 1:15-1:25 | Kim Honghyok | A Triple Threat in Climate Change: is the Effect of Heat Waves on Cause-Specific Mortality Intensified by Particulate Matter and Ozone Exposure? UIC CACHET |
| | 1:25-1:35 | Dongying Li | A Meta-Analysis of Climatic and Meteorological Factors and Mental Health: Recent Progress and Remaining Questions Texas A&M TICER |
| 1:25 pm - 2:15 pm | Panel Discussion 1: The BIG 4 – Hurricanes, Storms, Extreme Heat, and Wildfires | | |
| | Co-Chair | Marilyn Howarth- <i>representing CCH</i> | UPENN CEET |
| | Co-Chair | Brian Buckley- <i>representing DR2</i> | Rutgers CEED |
| | Panelist 1 | Perry Hystad | OSU Pacific Northwest |
| | Panelist 2 | Elizabeth Stone | UIOWA, EHSRC |
| | Panelist 3 | Deborah Watkins | Michigan M-LEEd |
| | Panelist 4 | Irva Hertz-Picciotto | UC Davis EHSC |
| 2:15 pm - 2:25 pm | Transition (10 min) | | |
| 2:25 pm - 3:15 pm | Panel Discussion 2: Effective Disaster Response and Adapting to Climate Change | | |
| | Co-Chair | Trevor Penning- <i>representing CCH</i> | UPENN CEET |
| | Co-Chair | Aubrey Miller- <i>representing DR2</i> | NIEHS |
| | Panelist 1 | Erin Haynes | UK CARES |
| | Panelist 2 | Nicholas Newman | UC CEG |
| | Panelist 3 | Kathleen M. Vandiver | MIP CEHS |
| | Panelist 4 | Jeremy Hess | UW EDGE Center |
| 3:15 pm - 3:45 pm | Open Forum, 30 min: Free-flowing suggestions from the audience about how to enhance the productivity of the CCH / DR2 community of practice across the NIH institutes | | |
| | Co-Chair | Stephen Linder | GC-CPEH |
| | Co-Chair | Kees Elferink | GC-CPEH |
| | Co-Chair | Ann Backus | Harvard Chan Center |
| | Speaker | Trevor Penning | UPENN CEET |
| | Speaker | Aubrey Miller | NIEHS |

KEYNOTE SPEAKERS



Dr. Rick Woychik was named Director of the National Institute of Environmental Health Sciences and the National Toxicology Program on June 7, 2020, after serving as Deputy Director since 2011. He is a molecular geneticist with a Ph.D. in molecular biology from Case Western Reserve University and postdoctoral training with Dr. Philip Leder at Harvard Medical School.

He spent almost 10 years at Oak Ridge National Laboratory rising in the ranks to become head of the Mammalian Genetics Section and then director of the Office of Functional Genomics. In August 1997, he assumed the role of vice chairman for research and professor in the Department of Pediatrics at Case Western Reserve University. In 1998, he moved to the San Francisco Bay area, first as the head of the Parke-Davis Laboratory for Molecular Genetics and then as chief scientific officer at Lynx Therapeutics. He returned to academics as the president and CEO of The Jackson Laboratory in August 2002 and served in that role until January 2011.



Thomas Hartung, MD PhD, holds five professorships at Johns Hopkins, Georgetown University and University of Konstanz. He directs Centers for alternatives to animal testing in the US and Europe and is the Field Chief Editor of Frontiers in Artificial Intelligence. He pioneers bioengineered microphysiological systems and AI for a scientific revolution in the safety sciences.

He is Field Chief Editor of Frontiers in Artificial Intelligence. He is the former Head of the European Commission's Center for the Validation of Alternative Methods (ECVAM), Ispra, Italy, and has authored more than 650 scientific publications with more than 44,000 citations (h-index 111). His toxicology classes on COURSERA had almost 17,000 active learners.

To view the meeting agenda and read short bios of the speakers, please scan the QR code



POSTER PRESENTATIONS

Presentation Set-Up & Viewing Schedule:

- Poster Set-Up: Tuesday, October 17, from 11:30 am – 1:00 pm - *Check your ID # on the poster board*
- **Networking and Poster Presentation Session: Tuesday, October 17, from 4:00 pm – 5:30 pm**
 - ⇒ 4-4:45: ESI/Climate/DR2
 - ⇒ 4:45 -5:30: CEC
- Breakfast & Poster Viewing: Wednesday, October 18 from 8:30 am – 9:30 am
- Poster viewing: Wednesday, October 18, from 12:30 pm – 1:30 pm
- Breakfast & Poster Viewing: Thursday, October 19 from 8:30 am – 9:30 am

ESI/Climate/DR2 Poster Presentation Date and Time: *Presenters listed below will present their posters during the Networking & Poster Session on Tuesday, October 17, from 4:00 to 4:45 p.m.*

| ESI ID | First | Last | Institution | P30 Center | Title of Talk |
|--------|---------------|--------------|---|---|--|
| 1 | Marie | Gaine | University of Iowa | University of Iowa Environmental Health Sciences Research Center (EHSRC) | The role of pesticides in increasing risk for depression and suicide |
| 2 | Rama | Gullapalli | University of New Mexico | New Mexico Integrative Science Program Incorporating Research in Environmental Sciences (NM-INSPIRES) | Hepatobiliary Cancers in New Mexico: Exploring the Role of Chronic, Low-Dose Exposure of Cadmium (CLEC) as a Model Metabolic Driver of Cancer Disparities |
| 3 | Elaine | Hayek | University of New Mexico | New Mexico Integrative Science Program Incorporating Research in Environmental Sciences (NM-INSPIRES) | Bioavailability and environmental health exposure to metals and plastics |
| 4 | Jelte | Kelchtermans | University of Pennsylvania | Center of Excellence in Environmental Toxicology (CEET) | Air pollution sensitivity as an underappreciated variable |
| 5 | Nalinikanth | Kotagiri | University of Cincinnati | UC's P30 Center for Environmental Genetics (CEG) | Programming the skin microbiome for protection against environmental insults |
| 6 | Sungmin | Lee | Texas A&M University | Texas A&M Center for Environmental Health Research (TiCER) | The Impact of Tree Canopy on Heat-Related Risks and Asthma Hospitalization |
| 7 | Shruthi | Mahalingaiah | Harvard TH Chan School of Public Health | The Harvard Chan NIEHS Center for Environmental Health | Understanding disparities in the diagnosis of polycystic ovary syndrome (PCOS) while preparing to include climate associated air pollution, temperature, and humidity in studies of ovulation health and disease |
| 8 | Michael | Petriello | Wayne State University | Wayne State University, Center for Urban Responses to Environmental Stressors Member (CURES) | Mixtures of Per- and polyfluoroalkyl substances (PFAS), modulate gut microbiota across the lifespan |
| 9 | Cetewayo | Rashid | University of Kentucky (UK) College of Medicine | UK Center for Appalachian Research in Environmental Sciences (UK-CARES) | Metabolic Consequences of Organophosphate Flame-Retardant Exposure |
| 10 | Meghan | Rebuli | University of North Carolina-Chapel Hill | Center for Environmental Health and Susceptibility (CEHS) | Characterizing sex-specific respiratory responses to model wildfire smoke in vivo and in vitro |
| 11 | Joseph Daniel | Romano | University of Pennsylvania | Center of Excellence in Environmental Toxicology (CEET) | Knowledge-driven artificial intelligence enables mechanistic computational toxicology |
| 12 | Vivek | Rudrapatna | University of California San Francisco (UCSF) | Environmental Research and Translation for Health (EaRTH) Center | A comparative environmental impact assessment of methods for performing colorectal cancer screening |
| 13 | Coralynn | Sack | University of Washington (UW) | UW Interdisciplinary Center on Exposures, Diseases, Genomics and the Environment (UW EDGE Center) | Airway Morphology in Environmental Lung Disease |
| 14 | Souvarish | Sarkar | University of Rochester | Rochester Environmental Health Sciences Center | Parkinson's disease: A tale of two cities, the genome and the exposome |
| 15 | Susan | Shen | University of California San Francisco (UCSF) | Environmental Research and Translation for Health (EaRTH) Center | Combinatorial effects of toxicants and psychoactive compounds on cellular health |
| 16 | Elise | Smith | The University of Texas Medical Branch | Gulf Coast Center for Precision Environmental Health (GC-CPEH) | Social Responsibility of Environmental Health Scientists Conducting Studies on Superfund Sites |
| 17 | Xiao | Wu | Columbia University | NIEHS Center for Environmental Health and Justice in Northern Manhattan, Member | Low-intensity fires mitigate the risk of catastrophic wildfires in California's forests and savannas. |

| Climate /DR2 | | | | | |
|--------------|--------|-----------------|-----------------------------------|--|--|
| ID | First | Last | Institution | P30 Center | Title of Talk |
| 18 | Paloma | Wood-Assemanian | UCSF | UCSF EaRTH Center | Climate Resilience and Environmental Sustainability Training |
| 19 | Noah | Scovronick | Emory University | Emory (HERCULES Exposome Research Center) | The distribution of air quality co-benefits from climate action: an analysis of exposure disparities across population sub-groups |
| 20 | Erika | Garcia | University of Southern California | Southern California Environmental Health Sciences Center | The need for solutions-oriented climate change and health research: case study of the Electric Vehicle Adoption in California (EVAC) study |
| 21 | Robbie | Parks | Columbia University | Environmental Health Sciences | Uncovering the Hidden Burden of Tropical Cyclones on Public Health Locally and Worldwide |
| 22 | Corina | Lesseur | Mount Sinai | Center on Health and Environment Across the LifeSpan | DNA methylation profiles reveal sex-specific associations between gestational exposure to ambient air pollution and placenta cell type composition |
| 23 | Astrid | Schnetzer | NC State University | NC State Center for Human Health and the Environment | Cyanotoxin exposure from shellfish consumption in NC coastal waters |
| 24 | Ann | Liu | NIEHS | | The New Rapid Acquisition of Pre- and Post-Incident Disaster Data (RAPIDD) Protocol Designer |

CEC Poster Presentation Date and Time: *Presenters listed below will be presenting their posters during the Networking & Poster Session on Tuesday, October 17, from 4:45 pm – 5:30 pm*

| CEC ID | First | Last | Institution | P30 Center | Title of Talk |
|--------|----------|------------|---|---|---|
| 25 | Tamar | Ginossar | University of New Mexico | New Mexico Integrative Science Program Incorporating Research in Environmental Sciences (NM-INSPIRES) | New Mexico Integrative Science Program Incorporating Research in Environmental Sciences Community Engagement Core |
| 26 | Adrian | Wood | University of Pennsylvania | Center of Excellence in Environmental Toxicology | Community Engagement at the Center of Excellence in Environmental Toxicology |
| 27 | Adrian | Wood | University of Pennsylvania | Center of Excellence in Environmental Toxicology | Targeted Community Engagement: PES Refinery Exposures |
| 28 | Jackie | Curnick | University of Iowa | Environmental Health Sciences Research Center | Overview of EHSRC CEC |
| 29 | Kathleen | Vandiver | Massachusetts Institute of Technology | MIT Center for Environmental Health Sciences (CEHS) | Malden River Works for Equity and Resilience |
| 30 | Craig | Wilmhoff | Buckhorn High School | University of Kentucky | An Assessment of Rural Appalachian Waterways Before and After a Historic Flood. |
| 31 | Ami | Zota | Columbia University Mailman School of Public Health | Center for Environmental Health and Justice in Northern Manhattan | Community Engagement Core, Center for Environmental Health and Justice in Northern Manhattan |
| 32 | Rebecca | Lauzon | University of Rochester | Rochester Environmental Health Sciences Center | Evaluating Environmental Health Science Kits in Promoting Environmental Health Literacy |
| 33 | Lisa | Hayward | University of Washington | EDGE Center | EDGE Community Engagement Core: Building engagement capacity within EDGE and facilitating collaborations |
| 34 | Diana | Rohlman | Oregon State University | Pacific Northwest Center for Translational Environmental Health Research | Creating a community-engaged research pilot study to address wildfire smoke exposure during pregnancy in Klamath County, OR |
| 35 | Katrina | Korfmacher | University of Rochester | Rochester Environmental Health Sciences Center | Low-cost particulate matter sensors: developing appropriate educational resources to support community use |
| 36 | Daisy | Magana | University of Illinois Chicago | The Chicago Center for Health and Environment (CACHET) | Creating Evaluation Infrastructure for the CACHET Community Engagement Core |
| 37 | Daisy | Magana | University of Illinois Chicago | The Chicago Center for Health and Environment (CACHET) | Measuring Partnership Authenticity & Effectiveness |
| 38 | Nicholas | Newman | University of Cincinnati | Center for Environmental Genetics | Helping Communities Recover from, Detect, Understand, and Prevent Exposures |
| 39 | Nicholas | Newman | University of Cincinnati | Center for Environmental Genetics | Partnering to Engage Clinicians for Environmental Health Education about PFAS |
| 40 | Mayra | Vargas | University of Arizona | Southwest Environmental Health Sciences | Southwest Environmental Health Sciences - Community Engagement Core |

| | | | | | |
|----|-----------|---------------|---|--|--|
| 41 | Katy | May | North Carolina State University | Center for Human Health and the Environment | How CHHE Engages Communities |
| 42 | Nadia | Pack | University of Illinois Chicago | ChicAgo Center for Health and EnvironmenT (CACHET) | Fostering Community Ideas: EnviroReport App |
| 43 | Jennifer | Ahumada | University of Southern California | Southern California Environmental Health Sciences Center | Developing Community-Based Actions to Address Air Pollution Concerns in Environmental Justice Neighborhoods: DIY Indoor Air Filter Workshops |
| 44 | Elizabeth | Kamai | University of Southern California | Southern California Environmental Health Sciences Center | Community Engagement at the Southern California Environmental Health Sciences Center |
| 45 | Kathleen | Gray | UNC-Chapel Hill | UNC-Chapel Hill Center for Environmental Health & Susceptibility | Building the Capacity of STEM Teachers to Use an Emerging Environmental Health Issue to Engage All Learners |
| 46 | Victoria | Triana | UNC-Chapel Hill | UNC-Chapel Hill Center for Environmental Health & Susceptibility | Pivot to Virtual Modeled Flexibility Needed for a Resilient Future |
| 47 | Jonathan | London | UC Davis | UC Davis EHSC | Building Capacity for Community Engaged Scholarship |
| 48 | Erin | Lebow-Skelley | Emory University | HERCULES | HERCULES Community Engagement Core Activities |
| 49 | Kerry | Butch | Rutgers University | Center for Environmental Exposures and Disease | Rutgers CEED: Partnering with New Jersey EJ Communities on Cumulative Impacts Action |
| 50 | Chris | Heaney | Johns Hopkins Bloomberg School of Public Health | CHARMED | Community Health: Addressing Regional Maryland Environmental Determinants of Disease (CHARMED) Center |
| 51 | Matthew | Aubourg | Johns Hopkins Bloomberg School of Public Health | CHARMED | Launching the CHARMED Center Community Engagement Core's Environmental Justice Partnerships Board (EJPB) and Summer Youth Environmental Justice (SY EJ) Scholars Program |

PLANNING COMMITTEE

| ting | Name (*Co-chairs) | Institution | Center Name | Center Role | Email |
|------|---|-------------|--|-------------------|--|
| 1 | Claudia Thompson | NIEHS | | | thompso1@niehs.nih.gov |
| 2 | Liam O'Fallon | NIEHS | | | ofallon@niehs.nih.gov |
| 3 | Cheryl Walker* | BCM | Gulf Coast Center for Precision Environmental Health (GC-CPEH) | Director | Cheryl.Walker@bcm.edu |
| 4 | Kees Elferink* | UTMB | GC-CPEH | Co-Director | coelferi@utmb.edu |
| 5 | Andrea Baccarelli* | Columbia | NIEHS Center for Environmental Health and Justice in Northern Manhattan | Director | ab4303@cumc.columbia.edu |
| 6 | Dana Dolinoy* | UMICH | Michigan Center on Lifestage Environmental Exposures and Disease (M-LEEAD) | Director | ddolinoy@umich.edu |
| 7 | Elaine Symanski | BCM | GC-CPEH | Deputy Director | Elaine.Symanski@bcm.edu |
| 8 | Sharon Croisant, <i>CEC Forum Organizer</i> | UTMB | GC-CPEH | CEC Director | spetrone@utmb.edu |
| 9 | Lea Steele | BCM | GC-CPEH | CEC Co-Director | Lea.Steele@bcm.edu |
| 10 | Stephen Linder | UTHealth | GC-CPEH | CEC Co-Director | Stephen.H.Linder@uth.tmc.edu |
| 11 | Abi Oluoyomi, <i>Climate/DR2 Organizer</i> | BCM | GC-CPEH | LDP/Navigator | Abiodun.Oluoyomi@bcm.edu |
| 12 | Heyreoun An Han, <i>General Meeting Organizer</i> | BCM | GC-CPEH | Administrator | heyreoun.anhan@bcm.edu |
| 13 | Irva Hertz-Picciotto | UC Davis | UC-Davis Environmental Health Sciences Core Center (EHSC) | Director | ihert@ucdavis.edu |
| 14 | Janine M LaSalle | UC Davis | EHSC | Deputy Director | jmlasalle@ucdavis.edu |
| 15 | Judy van de Water | UC Davis | EHSC | Pilot Co-Director | javandewater@ucdavis.edu |
| 16 | Gail S Prins | UIC | ChicAgo Center for Health and EnvironmenT (CACHET) | Director | gprins@uic.edu |
| 17 | Susan Pinney | UC | Center for Environmental Genetics (CEG) | Director | PINNEYSM@UCMAIL.UC.EDU |
| 18 | Tracey Woodruff | UCSF | UCSF Environmental Research and Translation for Health Center (EaRTH Center) | Director | Tracey.Woodruff@ucsf.edu |
| 19 | Xin Hu | Emory | HERCULES: Health and Exposome Research Center at Emory | Center Member | xin.hu2@emory.edu |
| 20 | Weston Porter | TAMU | Texas A&M Center for Environmental Health Research (TICER) | Director | wporter@cvm.tamu.edu |

MEETING LAYOUT

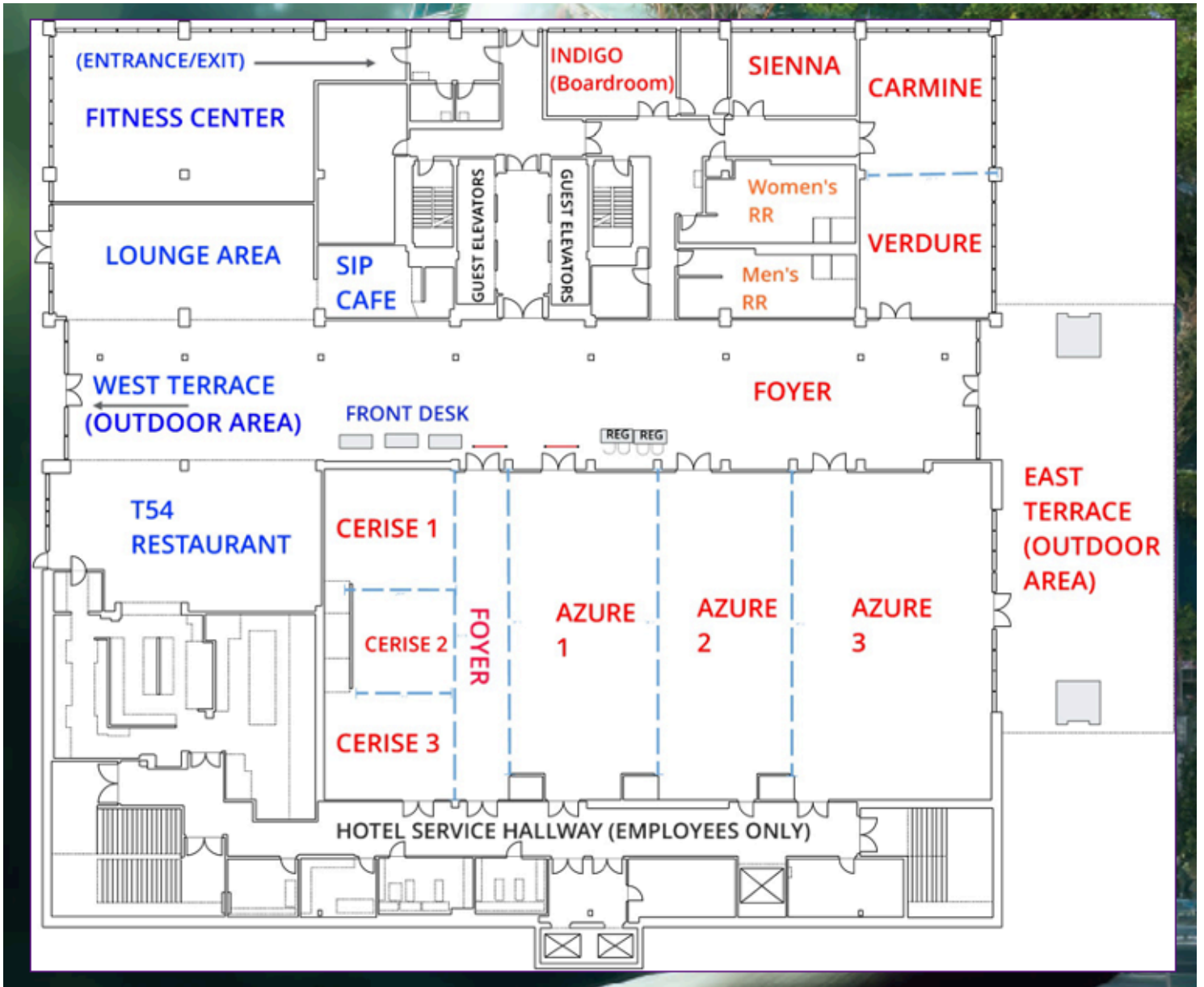

To view the meeting agenda and read short bios of the speakers, please scan the QR code

